

Suitable To : **ZF**

Springs & Slide Kits

 x 3

 x 3

Kit

**53**

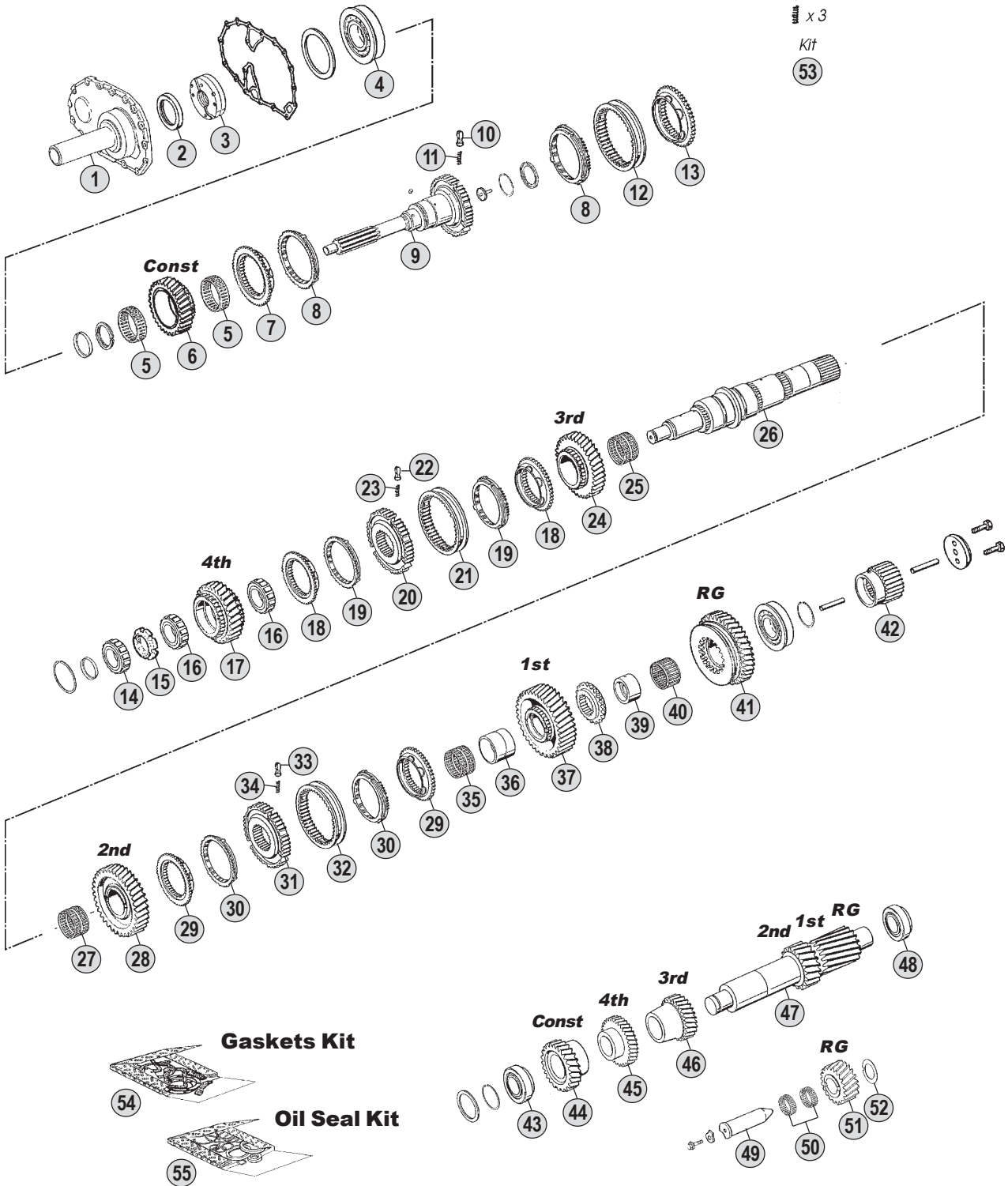

All original equipment manufacturers' numbers, symbols, pictures, models and description used in this catalogue are for reference only, and it is not implied that any part listed is the product of these manufactures. Tutti i nostri particolari non sono originali ma con essi intercambiabili. I riferimenti originali, le figure, i modelli sono esposti a semplice titolo indicativo. La nostra produzione riporta il nostro marchio.

**Ratios**

A : IRAN SSCH 11,64 - 0,83

B : MAZ 11,64 - 0,83

C :ZF do BRASIL 13,68 - 1,00

D : ZF do BRASIL 11,46 - 0,85

Fig.	CEI no.	Rif. ZF	Description	Q.ty	Note				
1	135.231	1297 302 012	Front Cover	1		●			
1	135.201	1297 302 042	Front Cover	1		●			
1	135.232	1297 302 169	Front Cover	1		●			
1	135.233	1297 302 268	Front Cover	1		●			
1	135.234	0091 302 268	Front Cover	1		●			
1	135.235	0091 302 306	Front Cover	1		●			
2	139.754	0734 310 386	Oil Seal 55x75x8	1		●			
2	139.937	0750 111 002	Oil Seal 48x75x8	1	Only for 0091 202 047	●			
3	<b>280.348</b>	1295 202 041	Oil Pump	1		●			
4	<b>130.305</b>	0750 118 131	Bearing 80x150x27,50	1		●			
5	<b>137.153</b>	0735 320 896	Needle Cage 88x96x29	2		●			
6	<b>244.069</b>	0091 302 276	Constant Gear 36 T	1	(A)	●			
6	146.761	0091 302 294	Constant Gear 36 T	1	(B)	●			
6	146.762	0091 302 160	Constant Gear 28 T	1	(C)	●			
6	146.766	0091 302 179	Constant Gear 30 T	1	(D)	●			
7	<b>109.784</b>	0091 304 310	Synchronizer Cone	1		●			
8	<b>119.167</b>	1297 304 484	Synchronizer Ring	2		●			
9	102.544	0091 202 047	Input Shaft	1	SSCH	●			
9	102.545	0091 202 062	Input Shaft	1	MAZ	●			
9	102.546	0091 202 024	Input Shaft 57 T	1	ZFBR	●			
9	102.547	0091 202 028	Input Shaft 57 T	1	ZFBR	●			
9	102.548	0091 202 031	Input Shaft	1	ZFBR	●			
9	102.549	0091 202 033	Input Shaft	1	ZFBR	●			
9	102.550	0091 202 034	Input Shaft	1	ZFBR	●			
9	102.551	0091 202 040	Input Shaft	1	ZFBR	●			
10	<b>160.189</b>	1297 304 436	Pressure Piece	3		●			
11	<b>156.140</b>	0732 040 409	Spring De.6,5x23,50	3		●			
12	<b>154.436</b>	1310 304 225	Sliding Sleeve	1		●			
13	<b>109.785</b>	0091 304 311	Synchronizer Cone	1		●			
14	137.113	0750 118 038	Roller Cage 35x68x27,50	1		●			
15	287.111	0501 398 371	Nut	1		●			
16	137.083	0750 118 005	Roller Cage 63x97,5x34,80	2		●			
17	<b>244.027</b>	0091 304 314	Gear 4th Speed 30 T	1	(ABC)	●			
17	244.182	0091 304 219	Gear 4th Speed 28 T	1	(D)	●			
18	<b>109.784</b>	0091 304 310	Synchronizer Cone	2		●			
19	<b>119.167</b>	1297 304 484	Synchronizer Ring	2		●			
20	<b>157.180</b>	1312 304 052	Synchronizer Hub	1		●			
21	<b>154.436</b>	1310 304 225	Sliding Sleeve	1		●			
22	<b>160.189</b>	1297 304 436	Pressure Piece	3		●			
23	<b>156.140</b>	0732 040 409	Spring De.6,5x23,50	3		●			
24	<b>244.028</b>	0091 304 317	Gear 3rd Speed 34 T	1	(ABC)	●			
24	244.183	0091 304 238	Gear 3rd Speed 35 T	1	(D)	●			
25	<b>137.109</b>	0735 320 452	Needle Cage 82x90x55	1		●			
26	<b>103.232</b>	0091 304 266	Main Shaft 38/38/34/28 T	1	(AC)	●			
26	103.277	0091 304 359	Main Shaft	1	(B)	●			

Notes

Date

02 / 2012

Table

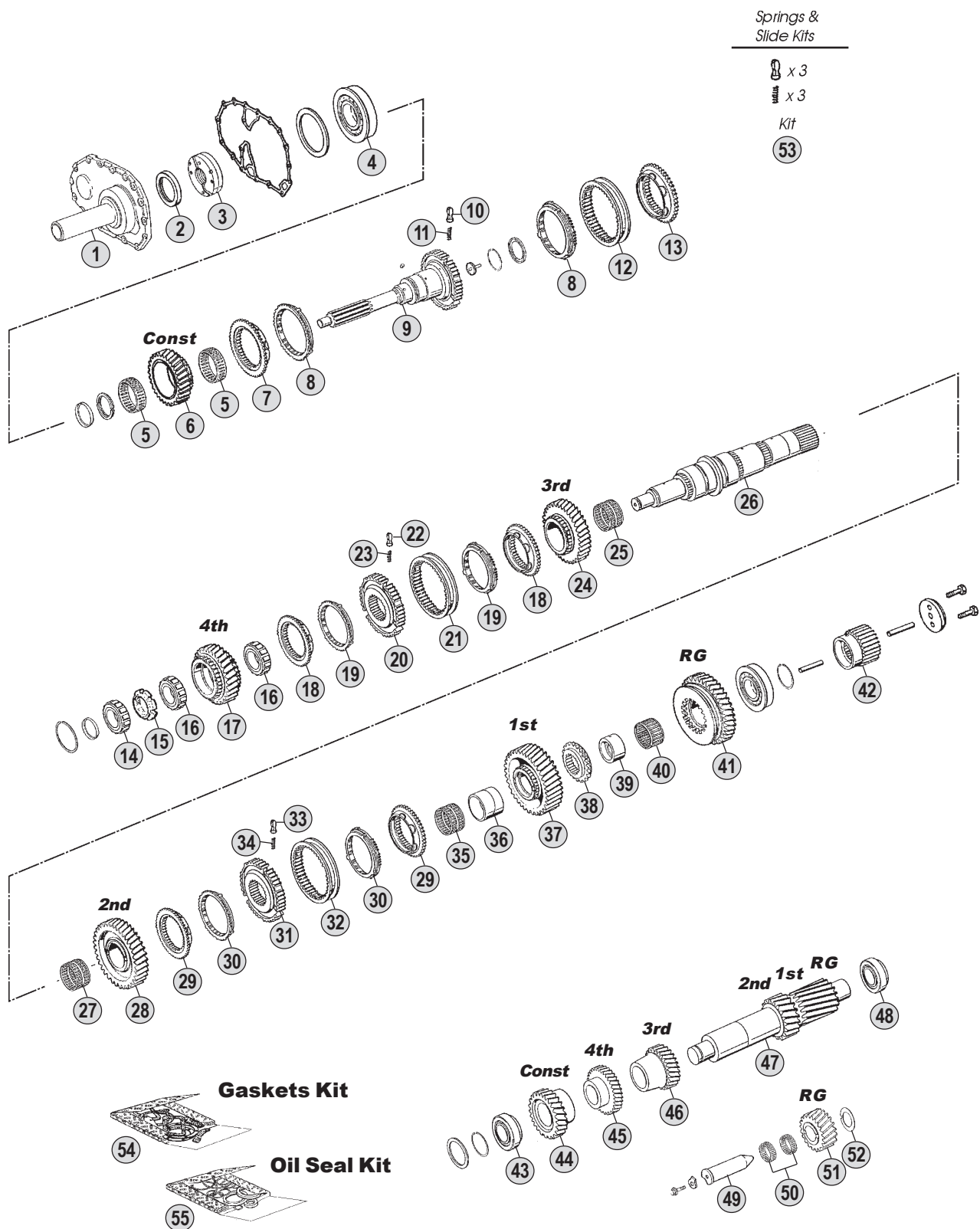
Suitable To : **ZF****16S1650**

All original equipment manufacturers' numbers, symbols, pictures, models and description used in this catalogue are for reference only, and it is not implied that any part listed is the product of these manufactures.  
 Tutti i nostri particolari non sono originali ma con essi intercambiabili. I riferimenti originali, le figure, i modelli sono esposti a semplice titolo indicativo. La nostra produzione riporta il nostro marchio.

**Ratios**

A : IRAN SSCH 11,64 - 0,83

B : MAZ 11,64 - 0,83

C :ZF do BRASIL 13,68 - 1,00

D : ZF do BRASIL 11,46 - 0,85

Fig.	CEI no.	Rif. ZF	Description	Q.ty	Note					
26	103.278	0091 304 267	Main Shaft	1	(D)	●				
27	<b>137.084</b>	0735 320 418	Needle Cage 82x90x49	1		●				
28	<b>244.025</b>	0091 304 191	Gear 2nd Speed 38 T	1	(ACD)	●				
28	244.184	0091 304 322	Gear 2nd Speed 38 T	1	(B)	●				
29	<b>109.817</b>	1316 304 154	Synchronizer Cone	2	(AB)	●				
29	109.851	0091 304 128	Synchronizer Cone	2	(CD)	●				
30	<b>119.218</b>	1316 304 170	Synchronizer Ring	2	(AB)	●				
30	<b>119.166</b>	1297 304 485	Synchronizer Ring	2	(CD)	●				
31	157.769	1316 304 179	Synchronizer Hub	1	(AB)	●				
31	157.770	0091 304 127	Synchronizer Hub	1	(CD)	●				
32	<b>154.358</b>	1316 304 169	Sliding Sleeve	1	(AB)	●				
32	<b>154.202</b>	1316 304 078	Sliding Sleeve	1	(CD)	●				
33	<b>160.189</b>	1297 304 436	Pressure Piece	3		●				
34	<b>156.140</b>	0732 040 409	Spring De.6,5x23,50	3		●				
35	<b>137.110</b>	0735 320 487	Needle Cage 82x90x68	1		●				
36	117.246	1297 304 035	Inner Bush	1		●				
37	<b>244.026</b>	0091 304 297	Gear 1st Speed 47 T	1		●				
38	109.818	0091 304 207	Synchronizer Cone	1		●				
39	117.318	1297 304 034	Bush	1		●				
40	<b>137.111</b>	0735 320 486	Needle Cage 78x86x44	1		●				
41	<b>147.255</b>	0091 304 210	Reverse Gear 38 T	1		●				
42	<b>157.230</b>	0091 304 194	Sun Gear 27 T	1	(ABC)	●				
42	157.771	0091 304 216	Sun Gear 24 T	1	(D)	●				
43	<b>130.242</b>	0750 117 010	Bearing 50,80x100x35	1		●				
44	<b>244.068</b>	0091 303 147	Constant Gear Z 31	1	(A)	●				
44	146.763	0091 303 157	Constant Gear 31 T	1	(B)	●				
44	<b>146.322</b>	1297 303 066	Constant Gear 34 T	1	(C)	●				
44	<b>146.383</b>	1297 303 074	Constant Gear 31 T	1	(D)	●				
45	<b>146.688</b>	0091 303 142	Gear 4th Speed 31 T	1	(ABC)	●				
45	146.764	0091 303 102	Gear 4th Speed 34 T	1	(D)	●				
46	<b>146.687</b>	0091 303 137	Gear 3rd Speed 25 T	1	(ABC)	●				
46	146.765	0091 303 106	Gear 3rd Speed 28 T	1	(D)	●				
47	<b>105.237</b>	0091 303 104	Countershaft 20/17 T	1	(ACD)	●				
47	105.281	0091 303 156	Countershaft	1	(B)	●				
48	<b>130.243</b>	0750 117 008	Bearing 50x110x42	1		●				
49	107.108	1295 305 056	Reverse Gear Pin	1		●				
50	<b>137.007</b>	0750 115 011	Needle Cage 45x53x21	2		●				
51	<b>147.094</b>	1295 305 052	Reverse Gear 24 T	1		●				
52	169.234	0730 150 064	Thrust Washer	1		●				
53	<b>198.843</b>	CEI 198843	Spring Slide Set	1		●				
54	298.850	1295 298 891	Gasket Kit	1		●				
55	298.851	1297 298 800	Oil Seal Kit	1		●				

Notes

Date

02 / 2012

Table

010

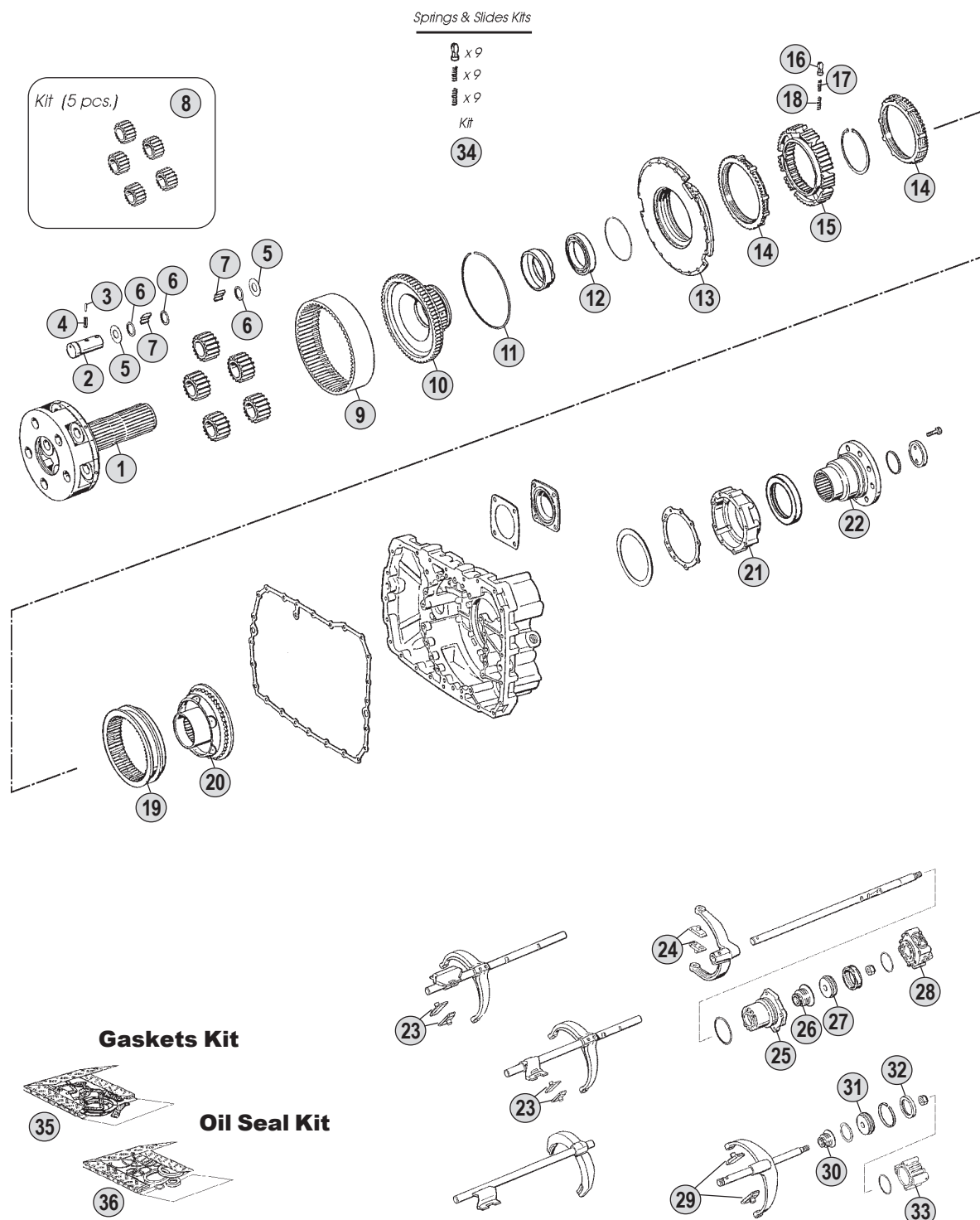
Suitable To : **ZF****16S1650****Ratios**

A : IRAN SSCH 11,64 - 0,83

B : MAZ 11,64 - 0,83

C :ZF do BRASIL 13,68 - 1,00

D : ZF do BRASIL 11,46 - 0,85

Fig.	CEI no.	Rif. ZF	Description	Q.ty	Note				
1	190.494	0091 232 022	Planetary Carrier	1	(AB)	●			
1	190.495	0091 232 013	Planetary Carrier	1	(C)	●			
1	190.496	0091 232 014	Planetary Carrier	1	(D)	●			
2	107.163	1297 332 109	Planet Shaft	5		●			
3	160.191	0631 329 017	Lock Pin 3x24	5		●			
4	160.192	0631 329 050	Lock Pin 5x24	5		●			
5	169.753	0501 306 212	Thrust Washer 29x64x1,5	10		●			
6	169.410	0730 103 846	Spacer Ring 29x39x1,00	15		●			
7	171.045	0750 119 143	Needle D.10x16,80	120		●			
8	198.803	1297 232 023	Planetary Gear Set (5 pcs)	1	(ABC)	●			
8	198.810	1297 232 024	Planetary Gear Set (5 pcs)	1	(D)	●			
9	123.217	1297 332 080	Crown Gear 83 T	1	(ABC)	●			
9	123.208	1295 332 086	Crown Gear 86 T	1	(D)	●			
10	150.257	0091 332 022	Carrier Hub	1	(ABC)	●			
10	150.137	1297 332 035	Carrier Hub 86 T	1	(D)	●			
11	111.129	0730 505 055	Locking Wire	1	(ABC)	●			
11	111.198	0730 505 056	Locking Wire	1	(D)	●			
12	130.310	0750 116 165	Bearing 80x110x16	1		●			
13	198.358	1296 233 006	Synchronizer Cone	1		●			
14	119.172	1296 333 045	Synchronizer Ring	2		●			
15	157.113	1296 333 002	Synchronizer Hub	1		●			
16	160.116	1240 304 278	Pressure Piece	9		●			
17	156.036	0732 040 386	Inner Spring De.3x34	9		●			
18	156.037	0732 040 385	Outer Spring De.6x34	9		●			
19	154.098	1296 333 023	Sliding Sleeve	1		●			
20	198.374	1313 233 001	Synchronizer Cone (38 Spl.)	1		●			
21	128.260	1296 301 067	Cover	1		●			
22	197.163	1297 338 038	Output Flange D.180	1		●			
22	197.167	1297 338 041	Output Flange D.180	1		●			
22	197.236	1297 338 051	Output Flange D.204	1		●			
23	141.163	1297 306 120	Slide	2		●			
24	141.163	1297 306 120	Slide	2		●			
25	132.046	1296 312 042	Cylinder	1		●			
26	139.331	0750 112 034	Cap Collar 25x38x14,2	1		●			
27	132.087	1296 312 056	Cylinder	1		●			
27	132.088	0091 312 016	Cylinder	1		●			
28	189.714	0501 396 632	Valve	1		●			
29	141.085	1296 334 004	Bronze Slide	2		●			
30	139.331	0750 112 034	Cap Collar 25x38x14,2	1		●			
31	189.422	1296 334 039	Piston	1		●			
32	139.336	0734 317 150	Seal Ring 80x90x4,8	2		●			
33	132.047	0750 132 027	Cylinder	1		●			
34	198.842	1295 298 933	Spring Slide Set	1		●			
35	298.850	1295 298 891	Gasket Kit	1		●			
36	298.851	1297 298 800	Oil Seal Kit	1		●			

Notes

Date

02 / 2012

Table

# ZF Index

ZF no.	CEI no.	Tab.	Fig.	ZF no.	CEI no.	Tab.	Fig.
0091 202 024	102.546	00010	9	0091 304 297	<b>244.026</b>	00010	37
0091 202 028	102.547	00010	9	0091 304 310	<b>109.784</b>	00010	7
0091 202 031	102.548	00010	9	0091 304 310	<b>109.784</b>	00010	18
0091 202 033	102.549	00010	9	0091 304 311	<b>109.785</b>	00010	13
0091 202 034	102.550	00010	9	0091 304 314	<b>244.027</b>	00010	17
0091 202 040	102.551	00010	9	0091 304 317	<b>244.028</b>	00010	24
0091 202 047	102.544	00010	9	0091 304 322	244.184	00010	28
0091 202 062	102.545	00010	9	0091 304 359	103.277	00010	26
0091 232 013	190.495	00015	1	0091 304 361	See	1312 304 052	
0091 232 014	190.496	00015	1	0091 312 016	132.088	00015	27
0091 232 022	190.494	00015	1	0091 332 022	150.257	00015	10
0091 302 160	146.762	00010	6	0501 306 212	<b>169.753</b>	00015	5
0091 302 179	146.766	00010	6	0501 309 421	See	0750 112 034	
0091 302 268	135.234	00010	1	0501 309 421	See	0750 112 034	
0091 302 276	<b>244.069</b>	00010	6	0501 396 632	189.714	00015	28
0091 302 294	146.761	00010	6	0501 398 371	287.111	00010	15
0091 302 306	135.235	00010	1	0631 329 017	<b>160.191</b>	00015	3
0091 303 093	See	0091 303 137		0631 329 050	<b>160.192</b>	00015	4
0091 303 094	See	0091 303 142		0635 338 049	See	0750 116 165	
0091 303 102	146.764	00010	45	0730 103 846	<b>169.410</b>	00015	6
0091 303 104	<b>105.237</b>	00010	47	0730 150 064	169.234	00010	52
0091 303 106	146.765	00010	46	0730 505 047	See	0730 505 055	
0091 303 137	<b>146.687</b>	00010	46	0730 505 055	111.129	00015	11
0091 303 142	<b>146.688</b>	00010	45	0730 505 056	111.198	00015	11
0091 303 147	<b>244.068</b>	00010	44	0732 040 385	<b>156.037</b>	00015	18
0091 303 156	105.281	00010	47	0732 040 386	<b>156.036</b>	00015	17
0091 303 157	146.763	00010	44	0732 040 409	<b>156.140</b>	00010	11
0091 304 109	See	0091 304 311		0732 040 409	<b>156.140</b>	00010	23
0091 304 127	157.770	00010	31	0732 040 409	<b>156.140</b>	00010	34
0091 304 128	109.851	00010	29	0734 310 111	See	0734 310 386	
0091 304 191	<b>244.025</b>	00010	28	0734 310 386	139.754	00010	2
0091 304 192	See	0091 304 317		0734 317 032	See	0734 317 150	
0091 304 193	See	0091 304 314		0734 317 150	139.336	00015	32
0091 304 194	<b>157.230</b>	00010	42	0735 320 042	See	0750 115 011	
0091 304 207	109.818	00010	38	0735 320 401	See	0735 320 418	
0091 304 210	<b>147.255</b>	00010	41	0735 320 418	<b>137.084</b>	00010	27
0091 304 216	157.771	00010	42	0735 320 452	<b>137.109</b>	00010	25
0091 304 217	See	0091 304 310		0735 320 486	<b>137.111</b>	00010	40
0091 304 217	See	0091 304 310		0735 320 487	<b>137.110</b>	00010	35
0091 304 219	244.182	00010	17	0735 320 896	<b>137.153</b>	00010	5
0091 304 238	244.183	00010	24	0735 370 055	See	0750 117 010	
0091 304 266	<b>103.232</b>	00010	26	0735 370 063	See	0750 117 008	
0091 304 267	103.278	00010	26	0735 410 240	See	0750 118 131	

Date

02 / 2012

Table

Index

ZF no.	CEI no.	Tab.	Fig.	ZF no.	CEI no.	Tab.	Fig.
0735 455 040	See	0750 118 038		1296 233 006	<b>198.358</b>	00015	13
0735 470 074	See	0750 119 143		1296 301 006	See	1296 301 067	
0750 111 002	139.937	00010	2	1296 301 067	128.260	00015	21
0750 112 018	See	0750 112 034		1296 312 003	See	1296 312 042	
0750 112 018	See	0750 112 034		1296 312 016	See	1296 312 042	
0750 112 019	See	0734 317 150		1296 312 042	132.046	00015	25
0750 112 034	139.331	00015	26	1296 312 056	132.087	00015	27
0750 112 034	139.331	00015	30	1296 333 002	<b>157.113</b>	00015	15
0750 115 011	<b>137.007</b>	00010	50	1296 333 011	See	1296 333 023	
0750 115 021	See	0735 320 452		1296 333 015	See	1296 333 002	
0750 116 165	<b>130.310</b>	00015	12	1296 333 023	<b>154.098</b>	00015	19
0750 117 008	<b>130.243</b>	00010	48	1296 333 044	See	1296 333 045	
0750 117 010	<b>130.242</b>	00010	43	1296 333 045	<b>119.172</b>	00015	14
0750 117 030	See	0750 117 010		1296 334 004	<b>141.085</b>	00015	29
0750 118 005	137.083	00010	16	1296 334 026	See	0750 132 027	
0750 118 038	137.113	00010	14	1296 334 039	189.422	00015	31
0750 118 126	See	0750 118 131		1296 334 046	See	0750 132 027	
0750 118 130	See	0750 118 131		1297 232 023	<b>198.803</b>	00015	8
0750 118 131	<b>130.305</b>	00010	4	1297 232 024	<b>198.810</b>	00015	8
0750 119 109	See	0750 119 143		1297 233 014	See	1313 233 001	
0750 119 143	<b>171.045</b>	00015	7	1297 233 018	See	1313 233 001	
0750 132 027	<b>132.047</b>	00015	33	1297 233 042	See	1313 233 001	
0769 170 966	See	1296 333 045		1297 233 057	See	1313 233 001	
1240 304 278	<b>160.116</b>	00015	16	1297 234 014	See	0750 132 027	
1268 304 510	See	1297 304 436		1297 234 016	See	0750 132 027	
1268 304 510	See	1297 304 436		1297 234 017	See	0750 132 027	
1268 304 510	See	1297 304 436		1297 298 800	298.851	00010	55
1269 202 087	See	1295 202 041		1297 298 800	298.851	00015	36
1269 202 093	See	1295 202 041		1297 302 012	135.231	00010	1
1295 202 035	See	1295 202 041		1297 302 042	135.201	00010	1
1295 202 041	<b>280.348</b>	00010	3	1297 302 169	135.232	00010	1
1295 202 050	See	1295 202 041		1297 302 268	135.233	00010	1
1295 202 054	See	1295 202 041		1297 303 039	See	1297 303 066	
1295 233 029	See	1296 233 006		1297 303 040	See	1297 303 074	
1295 298 891	298.850	00010	54	1297 303 066	<b>146.322</b>	00010	44
1295 298 891	298.850	00015	35	1297 303 074	<b>146.383</b>	00010	44
1295 298 933	<b>198.842</b>	00015	34	1297 304 034	117.318	00010	39
1295 305 008	See	1295 305 056		1297 304 035	117.246	00010	36
1295 305 052	<b>147.094</b>	00010	51	1297 304 436	<b>160.189</b>	00010	10
1295 305 056	107.108	00010	49	1297 304 436	<b>160.189</b>	00010	22
1295 332 086	<b>123.208</b>	00015	9	1297 304 436	<b>160.189</b>	00010	33
1295 334 075	See	0750 132 027		1297 304 484	<b>119.167</b>	00010	8
1296 233 005	See	1296 233 006		1297 304 484	<b>119.167</b>	00010	19

All original equipment manufacturers numbers, symbols, pictures, models and description used in this catalogue are for reference only, and it is not implied that any part listed is the product of these manufactures.  
Tutti i nostri particolari non sono originali ma con essi intercambiabili. I riferimenti originali, le figure, i modelli sono esposti a semplice titolo indicativo. La nostra produzione riporta il nostro marchio.

INDICE / INDEX  
Progressione ZF / ZF Progression

Date

02 / 2012

Table

Index



# ZF Index

ZF no.	CEI no.	Tab.	Fig.	ZF no.	CEI no.	Tab.	Fig.
1297 304 485	<b>119.166</b>	00010	30				
1297 306 120	<b>141.163</b>	00015	23				
1297 306 120	<b>141.163</b>	00015	24				
1297 332 005	See	1297 332 109					
1297 332 022	See	1297 232 023					
1297 332 028	See	1297 232 024					
1297 332 033	See	1295 332 086					
1297 332 035	<b>150.137</b>	00015	10				
1297 332 036	See	1297 332 080					
1297 332 080	<b>123.217</b>	00015	9				
1297 332 109	<b>107.163</b>	00015	2				
1297 338 038	<b>197.163</b>	00015	22				
1297 338 041	<b>197.167</b>	00015	22				
1297 338 051	197.236	00015	22				
1310 304 063	See	1316 304 078					
1310 304 067	See	1316 304 078					
1310 304 225	<b>154.436</b>	00010	12				
1310 304 225	<b>154.436</b>	00010	21				
1312 304 052	<b>157.180</b>	00010	20				
1313 233 001	<b>198.374</b>	00015	20				
1315 304 136	See	1316 304 169					
1316 304 078	<b>154.202</b>	00010	32				
1316 304 150	See	1316 304 170					
1316 304 152	See	1316 304 179					
1316 304 154	<b>109.817</b>	00010	29				
1316 304 169	<b>154.358</b>	00010	32				
1316 304 170	<b>119.218</b>	00010	30				
1316 304 179	157.769	00010	31				

Date

02 / 2012

Table

Index

CEI no.	ZF no.	Tab.	Fig.	CEI no.	ZF no.	Tab.	Fig.	CEI no.	ZF no.	Tab.	Fig.
102.544	0091 202 047	00010	9	135.232	1297 302 169	00010	1	156.140	0732 040 409	00010	34
102.545	0091 202 062	00010	9	135.233	1297 302 268	00010	1	157.113	1296 333 002	00015	15
102.546	0091 202 024	00010	9	135.234	0091 302 268	00010	1	157.180	1312 304 052	00010	20
102.547	0091 202 028	00010	9	135.235	0091 302 306	00010	1	157.230	0091 304 194	00010	42
102.548	0091 202 031	00010	9	137.007	0750 115 011	00010	50	157.769	1316 304 179	00010	31
102.549	0091 202 033	00010	9	137.083	0750 118 005	00010	16	157.770	0091 304 127	00010	31
102.550	0091 202 034	00010	9	137.084	0735 320 418	00010	27	157.771	0091 304 216	00010	42
102.551	0091 202 040	00010	9	137.109	0735 320 452	00010	25	160.116	1240 304 278	00015	16
103.232	0091 304 266	00010	26	137.110	0735 320 487	00010	35	160.189	1297 304 436	00010	10
103.277	0091 304 359	00010	26	137.111	0735 320 486	00010	40	160.189	1297 304 436	00010	22
103.278	0091 304 267	00010	26	137.113	0750 118 038	00010	14	160.189	1297 304 436	00010	33
105.237	0091 303 104	00010	47	137.153	0735 320 896	00010	5	160.191	0631 329 017	00015	3
105.281	0091 303 156	00010	47	139.331	0750 112 034	00015	26	160.192	0631 329 050	00015	4
107.108	1295 305 056	00010	49	139.331	0750 112 034	00015	30	169.234	0730 150 064	00010	52
107.163	1297 332 109	00015	2	139.336	0734 317 150	00015	32	169.410	0730 103 846	00015	6
109.784	0091 304 310	00010	7	139.754	0734 310 386	00010	2	169.753	0501 306 212	00015	5
109.784	0091 304 310	00010	18	139.937	0750 111 002	00010	2	171.045	0750 119 143	00015	7
109.785	0091 304 311	00010	13	141.085	1296 334 004	00015	29	189.422	1296 334 039	00015	31
109.817	1316 304 154	00010	29	141.163	1297 306 120	00015	23	189.714	0501 396 632	00015	28
109.818	0091 304 207	00010	38	141.163	1297 306 120	00015	24	190.494	0091 232 022	00015	1
109.851	0091 304 128	00010	29	146.322	1297 303 066	00010	44	190.495	0091 232 013	00015	1
111.129	0730 505 055	00015	11	146.383	1297 303 074	00010	44	190.496	0091 232 014	00015	1
111.198	0730 505 056	00015	11	146.687	0091 303 137	00010	46	197.163	1297 338 038	00015	22
117.246	1297 304 035	00010	36	146.688	0091 303 142	00010	45	197.167	1297 338 041	00015	22
117.318	1297 304 034	00010	39	146.761	0091 302 294	00010	6	197.236	1297 338 051	00015	22
119.166	1297 304 485	00010	30	146.762	0091 302 160	00010	6	198.358	1296 233 006	00015	13
119.167	1297 304 484	00010	8	146.763	0091 303 157	00010	44	198.374	1313 233 001	00015	20
119.167	1297 304 484	00010	19	146.764	0091 303 102	00010	45	198.803	1297 232 023	00015	8
119.172	1296 333 045	00015	14	146.765	0091 303 106	00010	46	198.810	1297 232 024	00015	8
119.218	1316 304 170	00010	30	146.766	0091 302 179	00010	6	198.842	1295 298 933	00015	34
123.208	1295 332 086	00015	9	147.094	1295 305 052	00010	51	198.843	CEI 198843	00010	53
123.217	1297 332 080	00015	9	147.255	0091 304 210	00010	41	244.025	0091 304 191	00010	28
128.260	1296 301 067	00015	21	150.137	1297 332 035	00015	10	244.026	0091 304 297	00010	37
130.242	0750 117 010	00010	43	150.257	0091 332 022	00015	10	244.027	0091 304 314	00010	17
130.243	0750 117 008	00010	48	154.098	1296 333 023	00015	19	244.028	0091 304 317	00010	24
130.305	0750 118 131	00010	4	154.202	1316 304 078	00010	32	244.068	0091 303 147	00010	44
130.310	0750 116 165	00015	12	154.358	1316 304 169	00010	32	244.069	0091 302 276	00010	6
132.046	1296 312 042	00015	25	154.436	1310 304 225	00010	12	244.182	0091 304 219	00010	17
132.047	0750 132 027	00015	33	154.436	1310 304 225	00010	21	244.183	0091 304 238	00010	24
132.087	1296 312 056	00015	27	156.036	0732 040 386	00015	17	244.184	0091 304 322	00010	28
132.088	0091 312 016	00015	27	156.037	0732 040 385	00015	18	280.348	1295 202 041	00010	3
135.201	1297 302 042	00010	1	156.140	0732 040 409	00010	11	287.111	0501 398 371	00010	15
135.231	1297 302 012	00010	1	156.140	0732 040 409	00010	23	298.850	1295 298 891	00010	54

All original equipment manufacturers numbers, symbols, pictures, models and description used in this catalogue are for reference only, and it is not implied that any part listed is the product of these manufactures.  
Tutti i nostri particolari non sono originali ma con essi intercambiabili. I riferimenti originali, le figure, i modelli sono esposti a semplice titolo indicativo. La nostra produzione riporta il nostro marchio.

# CEI Index

---

CEI no.	ZF no.	Tab. Fig.	CEI no.	ZF no.	Tab. Fig.	CEI no.	ZF no.	Tab. Fig.
298.850	1295 298 891	00015 35						
298.851	1297 298 800	00010 55						
298.851	1297 298 800	00015 36						

Date

---

02 / **2012**

Table

---

# Index



All original equipment manufacturers' numbers, symbols, pictures, models and description used in this catalogue are for reference only, and it is not implied that any part listed is the product of these manufactures.  
Tutti i nostri particolari non sono originali ma con essi intercambiabili. I riferimenti originali, le figure, i modelli sono esposti a semplice titolo indicativo. La nostra produzione riporta il nostro marchio.

**Ai Clienti / Importatori / Distributori prodotti C.E.I. S.p.A.:**

**“CONFORMITA’ A LEGGI E/O REGOLAMENTI SPECIFICI DELLA NAZIONE IMPORTATRICE”**

*C.E.I. S.p.A. assicura che i propri prodotti sono conformi alle Leggi e Regolamenti del Mercato Europeo e declina ogni responsabilità per applicazioni soggette a Leggi e Regolamenti specifici del Paese importatore, lasciando allo stesso la responsabilità di verificare la conformità del prodotto C.E.I. S.p.A. ai vincoli cogenti di Leggi e/o Regolamenti locali.*

*C.E.I. S.p.A. si dichiara disponibile, su richiesta del cliente, a valutare la possibilità di adeguare i propri prodotti ad eventuali specifiche esigenze che ci venissero sottoposte.*

**To Customer / Importers / Distributors of CEI Spa products :**

**“COMPLIANCE WITH LAWS AND/OR SPECIFIC REGULATIONS OF THE IMPORT COUNTRY”**

*C.E.I. S.p.A. ensures that its products conform to the laws and regulations of the European Community and declines any responsibility for applications subject to specific laws and regulations of the import country which is responsible to ascertain the conformity of CEI S.p.A. products to the local laws and/or regulations in force.*

*C.E.I. S.p.A. is available to evaluate the possibility of adapting its products for specific applications on request, should the need arise from any customer.*

**Aux clients / importateurs / distributeurs produits C.E.I. S.p.A.**

**“CONFORMITE AUX LOIS ET/OU REGLEMENTS SPECIFIQUES DU PAYS IMPORTATEUR “**

*La maison C.E.I. S.p.A. assure que ses produits sont conformes aux lois et règlements de la Communauté Européenne et décline toute responsabilité pour d'applications assujetties aux lois et règlements spécifiques du pays importateur , en laissant aux mêmes la responsabilité de vérifier la conformité du produit CEI aux obligations de lois et/ou règlements en vigueur propres du pays .*

*La maison C.E.I. S.p.A. se déclare disposée, sur requête du client, à évaluer la possibilité de conformer ses produits à d'éventuelles exigences spécifiques qui soient demandées.*

**A los clientes/importadores/distribidores del los productos CEI S.p.A.**

**“CONFORMIDAD A LAS LEYES Y/O LAS REGLAMENTACIONES ESPECIFICAS DE LA NACION IMPORTADORA “**

*CEI S.p.A certifica que sus productos están conformes con la leyes y las reglamentaciones del Mercado Europeo y declina cada responsabilidad por aplicaciones sujetas a leyes y reglamentaciones específicos del país importador, dejando al mismo la responsabilidad de averiguar la conformidad del producto CEI con los vinculos en vigencia de leyes y/o reglamentaciones locales.*

*CEI está disponible, bajo petición del cliente a evaluar la posibilidad de conformar sus productos con eventuales exigencias específicas.*